

Dimensions

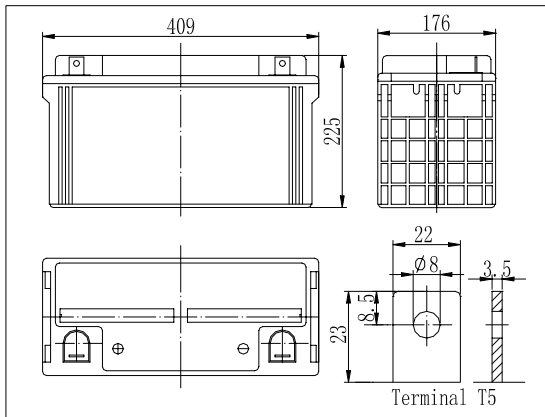

Specifications

Nominal Voltage	12 V	
Capacity(10HR, 25°C)	120 Ah	
Dimension	Length	409mm (16.1inch)
	Width	176mm (6.93inch)
	Height	225mm (8.86inch)
	Total Height	225mm (8.86inch)
Approx. Weight	37.5kg (82.7lbs)	
Internal resistance (Fully charged, 25°C)	Approx.4.3m Ω	
Capacity affected by temperature (10HR)	40°C	102%
	25°C	100%
	0°C	85%
	-15°C	65%
Self-discharge (25°C)	3 month	Remaining Capacity: 91%
	6 month	Remaining Capacity: 82%
	12 month	Remaining Capacity: 65%
Nominal operating temperature	25°C ± 3°C (77°F ± 5°F)	
Operating temperature range	-15°C ~ 50°C (5°F ~ 122°F)	
Float charging voltage(25°C)	13.50 to 13.80V	
Cyclic charging voltage(25°C)	14.50 to 14.90V	
Maximum charging current	36A	
Terminal material	Copper	
Maximum discharge current	960A(5 sec.)	

- ◆ Absorbent glass mat technology;
- ◆ Recognized by UL & CE;
- ◆ ABS container.

Charging Characteristics(25°C)

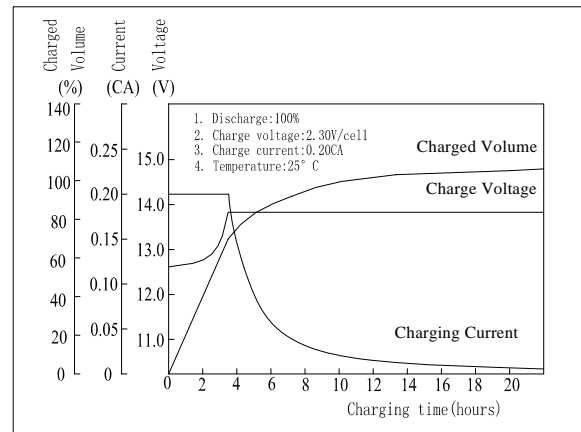

Floating Life Characteristics (25°C)

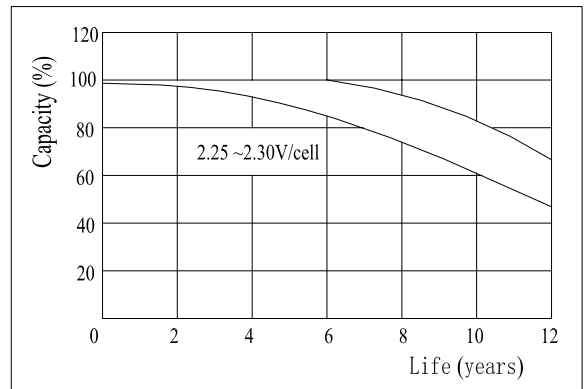

Note: Floating life at 20°C designed for more than 12 years

Constant Current Discharge Characteristics (A, 25°C)

F.V/TIME	5min	10min	15min	30min	60min	3h	5h	10h	20h
9.60V	359	243	204	126	78.0	31.0	21.9	12.2	6.35
10.2V	341	230	196	121	74.9	30.5	21.6	12.1	6.35
10.8V	320	217	186	115	71.2	29.9	21.2	12.0	6.20

Constant Power Discharge Characteristics (Watt, 25°C)

F.V/TIME	5min	10min	15min	30min	60min	3h	5h	10h	20h
9.60V	3768	2619	2237	1415	889	365	259	145	76.2
10.2V	3580	2488	2147	1358	854	359	255	144	76.2
10.8V	3365	2339	2040	1290	812	352	251	144	74.4