

Dimensions

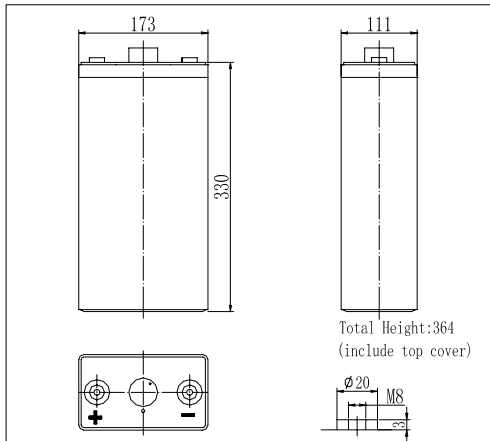

The Relationship for Open Circuit Voltage and Residual Capacity (25°C)

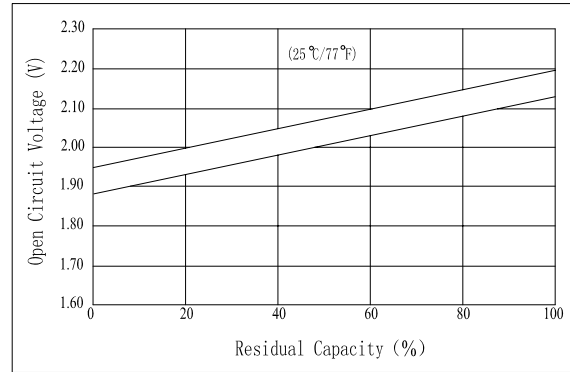

Specifications

Nominal Voltage	2 V	
Capacity(10HR, 25°C)	250 Ah	
Dimension	Length	173mm (6.81inch)
	Width	111mm (4.37inch)
	Height	330mm (12.99inch)
	Total Height	364mm (14.33inch)
Approx. Weight	15.5kg (34.2lbs)	
Internal resistance (Fully charged, 25°C)	Approx. 0.67mΩ	
Capacity affected by temperature (20HR)	40°C	102%
	25°C	100%
	0°C	85%
	-15°C	65%
Self-discharge (25°C)	3 month	Remaining Capacity: 91%
	6 month	Remaining Capacity: 82%
	12 month	Remaining Capacity: 65%
Nominal operating temperature	25°C ± 3°C (77°F ± 5°F)	
Operating temperature range	-15°C ~ 50°C (5°F ~ 122°F)	
Float charging voltage(25°C)	2.25 to 2.30V	
Cyclic charging voltage(25°C)	2.42 to 2.48V	
Maximum charging current	50A	
Terminal material	Copper	
Maximum discharge current	1800A(5 sec.)	

Charging Characteristics(25°C)

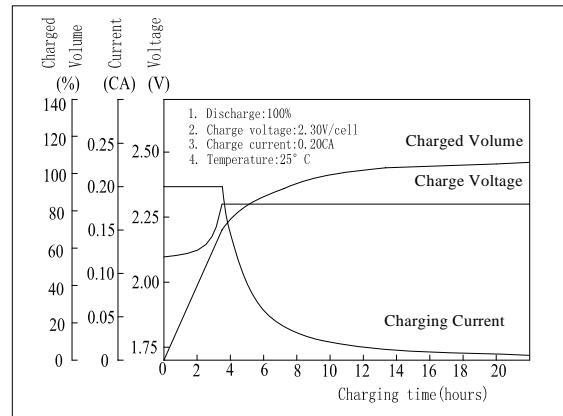

- ◆ Absorbent glass mat technology;
- ◆ Recognized by UL & CE;
- ◆ ABS container.

Temperature Affects On Floating Life

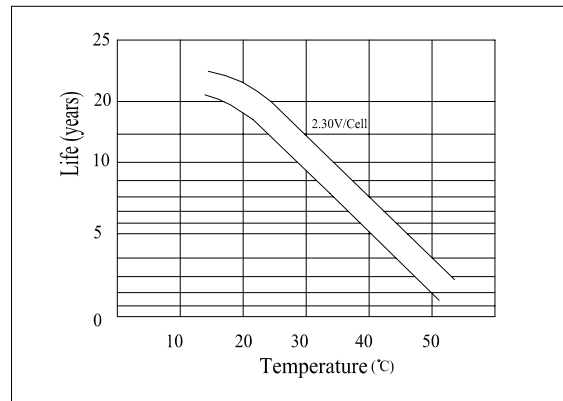

Note: Floating life at 20°C designed for 15 to 18 years.

Constant Current Discharge Characteristics (A, 25°C)

F.V/TIME	5min	10min	15min	30min	60min	3h	5h	10h	20h
1.60V	763	513	400	250	163	64.7	46.2	25.4	13.3
1.70V	724	487	384	240	156	63.8	45.5	25.2	13.2
1.80V	681	458	365	228	148	62.5	44.6	25.0	13.1

Constant Power Discharge Characteristics (Watt, 25°C)

F.V/TIME	5min	10min	15min	30min	60min	3h	5h	10h	20h
1.60V	1334	923	732	468	309	127	91.0	50.5	26.6
1.70V	1268	876	703	449	296	125	89.6	50.0	26.4
1.80V	1192	824	668	426	282	122	87.8	50.0	26.3