

Dimensions

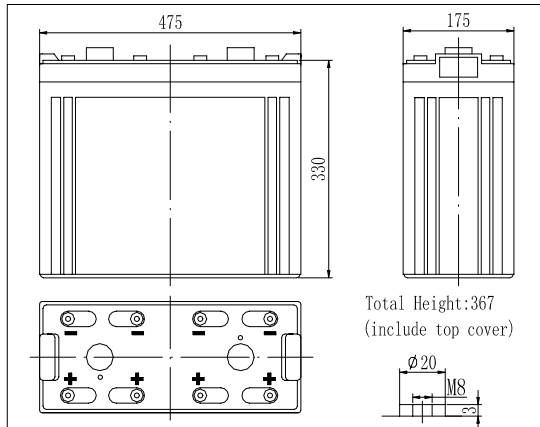

Specifications

Nominal Voltage	2 V	
Capacity(10HR, 25°C)	1000 Ah	
Dimension	Length	475mm (18.70inch)
	Width	175mm (6.89inch)
	Height	330mm (12.99inch)
	Total Height	367mm (14.45inch)
Approx. Weight	65kg (143.3lbs)	
Internal resistance (Fully charged, 25°C)	Approx. 0.20mΩ	
Capacity affected by temperature (20HR)	40°C	102%
	25°C	100%
	0°C	85%
	-15°C	65%
Self-discharge (25°C)	3 month	Remaining Capacity: 91%
	6 month	Remaining Capacity: 82%
	12 month	Remaining Capacity: 65%
Nominal operating temperature	25°C ± 3°C (77°F ± 5°F)	
Operating temperature range	-15°C ~ 50°C (5°F ~ 122°F)	
Float charging voltage(25°C)	2.25 to 2.30V	
Cyclic charging voltage(25°C)	2.42 to 2.48V	
Maximum charging current	200A	
Terminal material	Copper	
Maximum discharge current	7500A(5 sec.)	

- ◆ Absorbent glass mat technology;
- ◆ Recognized by UL & CE;
- ◆ ABS container.

Constant Current Discharge Characteristics (A, 25°C)

F.V/TIME	5min	10min	15min	30min	60min	3h	5h	10h	20h
1.60V	3100	2100	1650	1050	650	264	188	102	53.8
1.70V	2945	1995	1584	1008	624	260	185	101	53.3
1.80V	2768	1875	1505	958	593	255	181	100	53.0

Constant Power Discharge Characteristics (Watt, 25°C)

F.V/TIME	5min	10min	15min	30min	60min	3h	5h	10h	20h
1.60V	5425	3780	3020	1964	1235	517	370	202	108
1.70V	5154	3591	2899	1885	1186	510	364	200	107
1.80V	4845	3376	2754	1791	1126	499	357	200	106

Charging Characteristics(25°C)

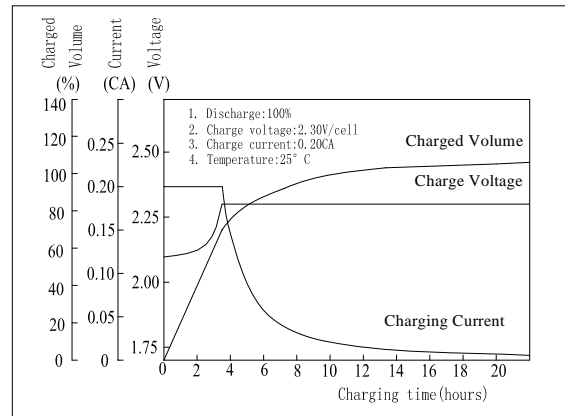

Temperature Affects On Floating Life

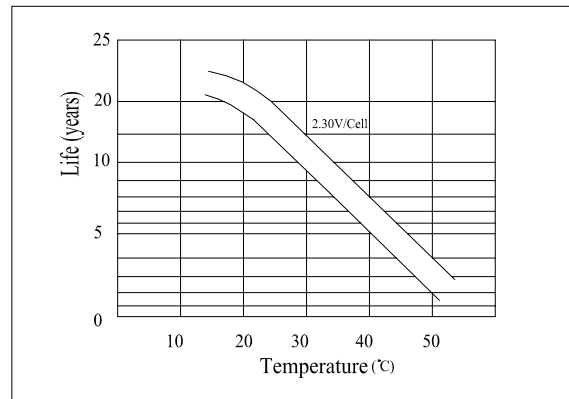

Note: Floating life at 20°C designed for 15 to 18 years.