

Dimensions

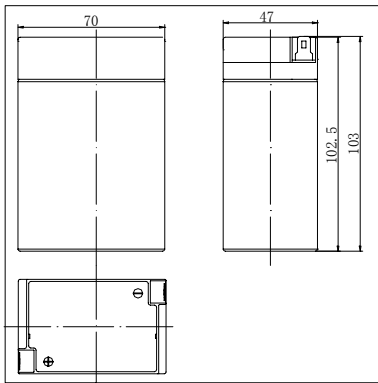

The Relationship for Open Circuit Voltage and Residual Capacity (25°C)

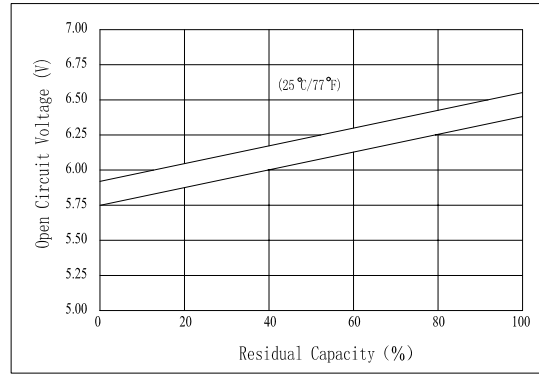

Specifications

Nominal Voltage		6 V
Capacity(20HR, 25°C)		4 Ah
Dimension	Length	70mm (2.76inch)
	Width	47mm (1.85inch)
	Height	102.5mm (4.04inch)
	Total Height	103mm (4.06inch)
Approx. Weight		0.70kg (1.54lbs)
Internal resistance (Fully charged, 25°C)		Approx. 28mΩ
Capacity affected by temperature (20HR)	40°C	102%
	25°C	100%
	0°C	85%
	-15°C	65%
Self-discharge (25°C)	3 month	Remaining Capacity: 91%
	6 month	Remaining Capacity: 82%
	12 month	Remaining Capacity: 65%
Nominal operating temperature		25°C ± 3°C (77°F ± 5°F)
Operating temperature range		-15°C ~ 50°C (5°F ~ 122°F)
Float charging voltage(25°C)		6.80 to 6.90V
Cyclic charging voltage(25°C)		7.25 to 7.45V
Maximum charging current		1.2A
Terminal material		Copper
Maximum discharge current		60A(5 sec.)

Charging Characteristics(25°C)

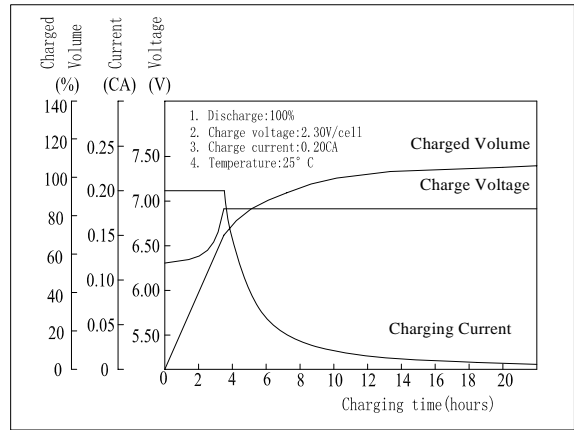

- ◆ Absorbent glass mat technology;
- ◆ Recognized by UL & CE;
- ◆ ABS container.

Cycle Life(25°C)

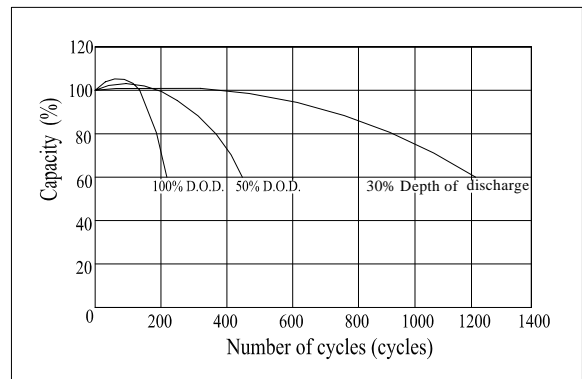

Note: Floating life at 20°C designed for 3 to 5 years.

Constant Current Discharge Characteristics (A, 25°C)

F.V/TIME	5min	10min	15min	30min	60min	3h	5h	10h	20h
4.80V	14.4	9.20	8.00	4.80	2.62	1.02	0.70	0.37	0.20
5.10V	13.7	8.74	7.68	4.61	2.52	1.00	0.69	0.37	0.20
5.40V	12.9	8.22	7.30	4.38	2.39	0.98	0.68	0.37	0.20

Constant Power Discharge Characteristics (Watt, 25°C)

F.V/TIME	5min	10min	15min	30min	60min	3h	5h	10h	20h
4.80V	80.4	51.9	44.6	24.6	15.3	5.76	4.12	2.28	1.20
5.10V	76.4	49.3	42.8	23.7	14.6	5.70	4.06	2.28	1.20
5.40V	72.0	46.4	40.6	22.5	13.9	5.58	4.00	2.22	1.20