

Dimensions

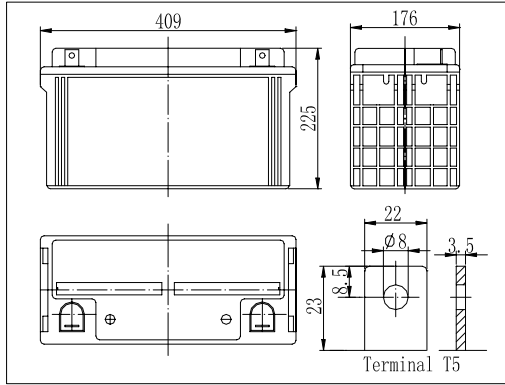

The Relationship for Open Circuit Voltage and Residual Capacity (25°C)

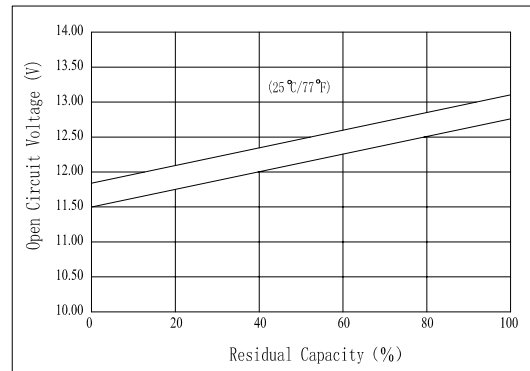

Specifications

Nominal Voltage		12 V
Capacity(10HR, 25°C)		120 Ah
Dimension	Length	409mm (16.1inch)
	Width	176mm (6.93inch)
	Height	225mm (8.86inch)
	Total Height	225mm (8.86inch)
Approx. Weight		38kg (83.8lbs)
Internal resistance (Fully charged, 25°C)		Approx.4.4m Ω
Capacity affected by temperature (10HR)	40°C	102%
	25°C	100%
	0°C	85%
	-15°C	65%
Self-discharge (25°C)	3 month	Remaining Capacity: 91%
	6 month	Remaining Capacity: 82%
	12 month	Remaining Capacity: 65%
Nominal operating temperature		25°C ± 3°C (77°F ± 5°F)
Operating temperature range		-15°C ~ 50°C (5°F ~ 122°F)
Float charging voltage(25°C)		13.50 to 13.80V
Cyclic charging voltage(25°C)		14.10 to 14.40V
Maximum charging current		30A
Terminal material		Copper
Maximum discharge current		960A(5 sec.)

Charging Characteristics(25°C)

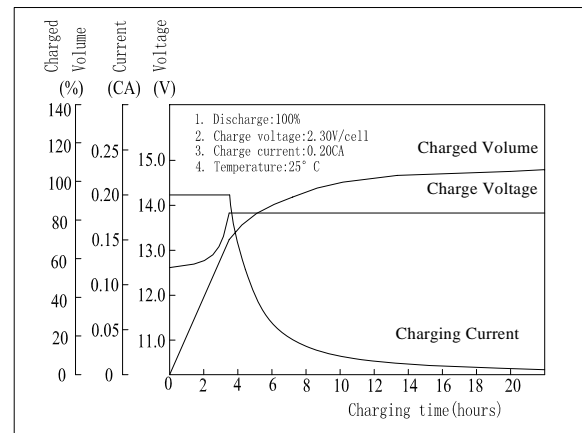

Cycle Life (25°C)

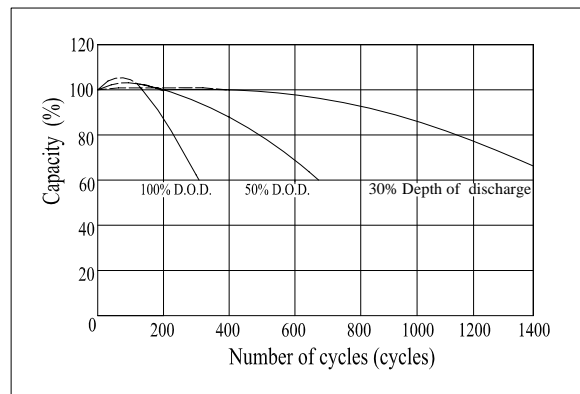

Note: Floating life at 20°C designed for 12 years.

- ◆ Gelled electrolyte technology;
- ◆ AGM separator;
- ◆ Recognized by UL & CE;
- ◆ ABS container.

Constant Current Discharge Characteristics (A, 25°C)

F.V/TIME	5min	10min	15min	30min	60min	3h	5h	10h	20h
9.60V	259	198	182	118	74.4	29.2	20.0	12.2	6.27
10.2V	246	188	175	113	71.4	28.8	19.7	12.1	6.22
10.8V	231	177	166	107	67.9	28.2	19.3	12.0	6.18

Constant Power Discharge Characteristics (Watt, 25°C)

F.V/TIME	5min	10min	15min	30min	60min	3h	5h	10h	20h
9.60V	2722	2138	2003	1319	848	344	236	145	75.3
10.2V	2586	2031	1923	1267	814	339	233	144	74.6
10.8V	2430	1910	1827	1203	774	332	228	143	74.2

Note: we can produce other type gelled batteries according with clients requirements.